

# DLyte11<sup>®</sup>



*DLyte11* series are the new patented machines for grinding and polishing Steel, Stainless-steel, Cobalt Chrome, Nickel, Titanium and Precious Metals.

Machine patented and manufactured by **GPAINNOVA**



The use of Patented DryLyte Technology is a concession approved by DryLyte Company

## DLYTE 11 TECHNICAL SPECIFICATIONS

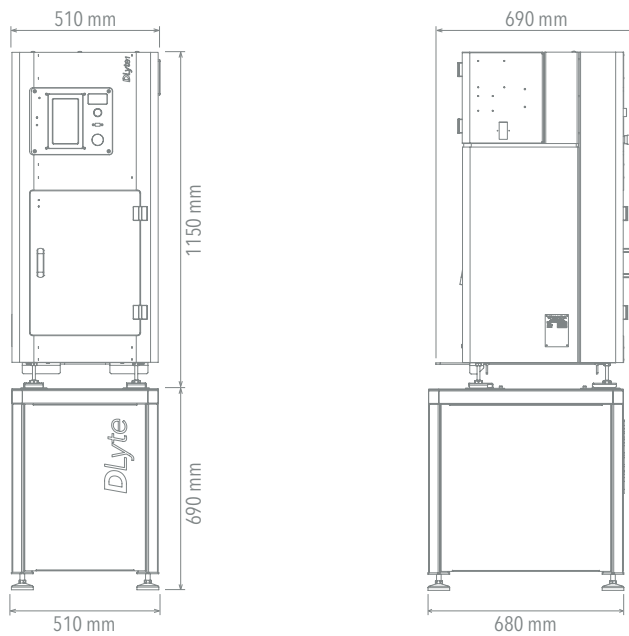

### MAIN DATA

Capacity (per cycle)	75Ø x50 mm (maximum volume centered to the axis)
Machine dimensions	510 x 1150 x 690 mm
Support dimensions	510 x 690 x 680 mm
Machine weight	96 kg
Support weight	47 kg
Power	2 kW
Voltage	220-240 V (*)
Air pressure	4-5 bar (air connector: 8mmØ or 1/4" BSP')

(\*) Provided with a male type G plug.

SERIES MODEL	MATERIALS	FREQUENCY
DLyte11	For Steel, SS, CoCr, Nickel and Precious Metals	LF
DLyte11Ti	For Titanium	HF
DLyte11+Ti	For Steel, SS, CoCr, Nickel, Titanium and Precious Metals	LF and HF